

ДАЧА

DASH ARTS DACHA



DACHA AT THE BRITISH LIBRARY

Retreat from the confusion and chaos of the revolution this summer to our Dacha - a rural summer idyll, an oasis of cushions, rugs and home comforts, an ever-changing enchanted space laced with performance, music, and a kitchen stocked with vodka, hot tea and snacks. Our Russian country house, the Dacha, explores life in the summer of 1917 through the eyes of the Popov family dacha in Vyritsa, several hours outside Petrograd.

'Visitors were greeted with traditional cherry jam tea, card games, live music and the most fun, raucous late-night dancing at the festival...' *The Observer* (2016)



Lose yourself in board games and cards, sip tea from the samovar that keeps on giving, partake in fevered political discussion with special guest speakers and enjoy live music and impromptu theatre performances where audiences can pick up a script and help us bring to life a play by some of the extraordinary avant-garde playwrights and artists of the turbulent revolutionary time.

Dash Arts Dacha is curated by Dash Arts co-Artistic Directors Josephine Burton and Tim Supple, designed by Bryan Woltjen with support from Professor Stephen Lovell, Kings College London (author of *Summerfolk: A History of the Dacha 1710-2000* and packed with hidden text, musicians, actors, activists and thinkers.

"The most fabulous evocative creative space with astoundingly good music. Thank you! (Plus great tea)" Clare Needham-Potts



Dash Arts creates artistic experiences that change the way we see the world. Founded in 2005 by our co-Artistic Directors, Dash Arts has created award winning new work in India, North Africa and the Middle East and currently in the midst of *REVOLUTION17*: an explosion of performance by artists from across the Post Soviet States.

For more information, contact Sherry Neyhus, Dash Arts Administrative Producer, sherry@dasharts.org.uk





Suggested programme:

Dates: We propose opening on Thursday, 27 April (to be open alongside the opening of the exhibition) and running through Sunday, 14 May. Most of the labour to install the *Dacha* will come from our own crew so we believe we could get-in alongside the build of the main exhibition.

Daily Activity: Our *Dacha* will be open at all times that the Library is open to the public. There will always be at least one member of the Popov household in situ, inviting visitors into the *Dacha* and engaging with them as much or as little as is required. The samovar will always be on, tea and snacks available, books and games on the shelves and in the 'library' space we will show short films on a loop.

The proposed schedule of *Dacha* activity is proposed as follows:

Saturday 29th April

- 1100-1230 Morning Games: Join the *Dacha* Family for their morning ritual
- 1230-1315 Belarusian troubadour **Sasha Ilyukevich** plays a set inspired by the beautiful poetry of the silver age
- 1400-1600 Impromptu performance of **Summerfolk** by **Maxim Gorky** (1905) translated by **Nick Dear**
- 1600-1700 Around the Kitchen Table : a conversation with playwright **Nick Dear**, adaptor of **Summerfolk**
- 1730-1800 Belarusian troubadour **Sasha Ilyukevich** plays a set inspired by the beautiful poetry of the age
- 1800-1930 Film: **Russian Ark** (2002) directed by **Alexander Sokurov**

Sunday 30th April

- 1100-1230 Morning Games: Join the *Dacha* Family for their morning ritual
- 1230-1315 Ukrainian songstress **Elena Dana** blends ballads and folk music
- 1400-1600 Impromptu performance of **Vassa Zheleznova** by Maxim Gorky
- 1600-1700 Around the Kitchen Table: with chef and food historian **Katrina Kolleagaeva**
- 1730-1800 Ukrainian songstress **Elena Dana** blends ballads and folk music
- 1800-1930 Film: **Earth** (1930) directed by **Alexander Dovzhenko**

Monday 1st May

- 1100-1230 Morning Games: Join the *Dacha* Family for their morning ritual
- 1230-1315 **Iryna Muha** beguiles us with Russian and Ukrainian folk songs.
- 1400-1600 Impromptu performance of **Mikhail Bulgakov's** *White Guard*
- 1600-1700 Around the Kitchen Table : a conversation with **Simon Sebag Montefiore / Helen Dunmore** on setting fiction in the *Dacha*
- 1730-1800 **Iryna Muha** beguiles us with Russian and Ukrainian folk songs.
- 1800-1930 FILM: Director **Nikita Mikhalkov's** *Unfinished Piece for the Piano* (1977) based on a Chekhov play set in an Tsarist *Dacha*

Wednesday 3rd

1300-1400 Around the Kitchen Table: conversation with **Katya Gerasimova** and **Bryan Woltjen** on Dacha interior design

Friday 5th May

1300-1400 **Mazaika Duo** with their intoxicating blend of Russian folk songs, jazz, tango and gypsy fiddle

Monday 8th May

1300-1400 Belarusian troubadour **Sasha Ilyukevich** plays a set inspired by the beautiful poetry of the silver age

Tuesday 9th May

1930-2100 Summerfolk: Life in the Dacha with Professor **Stephen Lovell**, chef **Olia Hercules** and **Orlando Figues**

Thursday 11th May

1300-1400 Around the Kitchen Table: The Revolution in the Dacha TBC speakers

Saturday 13th May

1100-1230 Morning Games: Join the Dacha Family for their morning ritual

1230-1315 Ukrainian songstress **Elena Dana** blends ballads and folk music

1400-1600 Impromptu performance of **Anton Chekhov's** Seagull

1600-1700 Around the Kitchen Table: Chekhov and the White Dacha with Dr **Oliver Ready**

1730-1800 Ukrainian songstress **Elena Dana** blends ballads and folk music

1800-1930 FILM: Director **Nikita Mikhalkov's** Unfinished Piece for the Piano (1977) based on a Chekhov play set in an Tzarist Dacha



Dacha Design

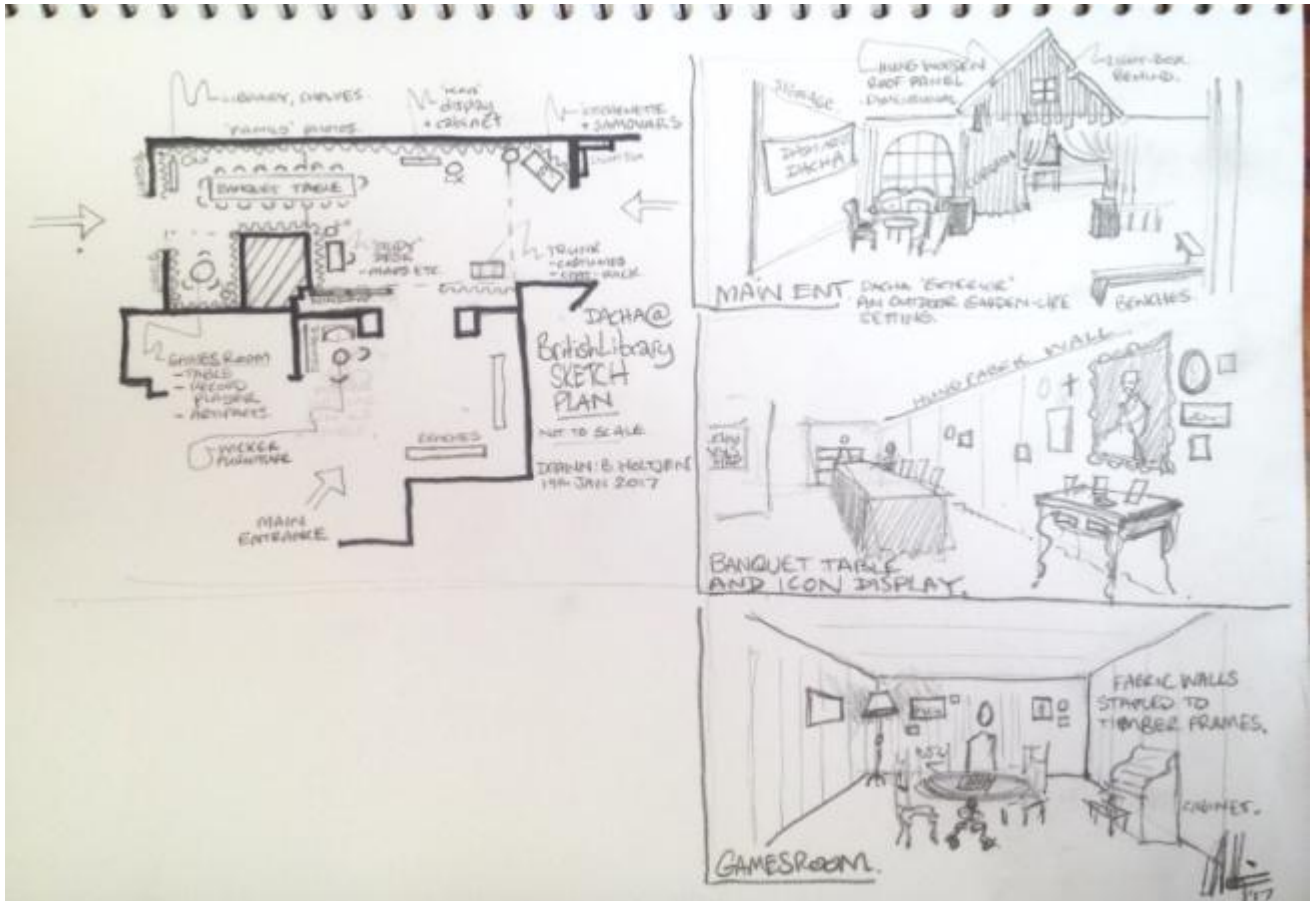

The Dash Arts Dacha is a timeless, flexible format, multi-artform audience inclusive experience that will jettison us into the Popov's summerhouse. The Popov's warm inviting cheerful characterful holiday home away from home hosts games, play-readings, film-nights, live music and endless tea from the bottom-less samovar. Utilising the framework and footprint of the traditional dacha, the design seeks to thrust the participant into a safe but politically charged environment, in the midst of the revolutions. The hallmarks are all in place. In fact, the finest amongst them immediately to be seen as you enter the hall, a resplendent display of icons, central amongst them, the beloved (or is he?) Czar, surrounded by icons above an intricate and delicate table of religious tokens.

- ❖ To one end, the kitchenette laden with steaming samovar, billowing out the inviting scent of Russian tea. Surrounding the samovar like a halo are Muscovite snacks, pickled fare from the garden and fresh bread.
- ❖ To the other, a study. A desk laden with letters to and from old Popov's wide sphere of influence. An old map adorns the wall above, and surrounding it are treasured photos of friends and family.
- ❖ Around the corner we enter a games-room, and in here we find a table, it is here that bold new discussions will begin, plots made and die thrown. The games-room also functions as a library, and books adorn the shelves interspersed by babushkas, collectables and meubles from across the continent.

Integrated through the Dacha, are discrete texts, located within shelves, frames, shelves of bureau. These texts are translations (where relevant) from great classic works of Russian literature and plays which refer to the experience of the Dacha – drawn from Nabokov, Chekhov, Tolstoy and Gorky. Throughout the day, the space transforms with the activities that take place. Tables are brought out to welcome more guests and the main hallway area becomes a dining space, a performance space or a space to dance. The hosts gather support from the public to transform the space, and in doing so, make it their own.

The Dacha at the British Library in 2017

Dash Arts will deliver the Dacha as a performance-ready, self-contained event suited for the mezzanine space. Dash Arts programmes and books all activities and performances within the Dacha

Rider:

- Main flexible space. Backstage areas for change room, storeroom and/or wetroom and green room (some of these spaces can be combined) with secure, lockable storage for participants.
- Up to 3 phase power supply
- Mini PA system suitable for live performance and films. Some external and basic internal lighting.
- Access to water, trestle tables and chairs, costume rail, secure lockable area, fridge/freezer
- Get-in times vary on the length of engagement but ideally we would require three full days prior to opening. Get-out is one day.

Budget: See attached



British Library: The Dacha

EXPENSES

| | | |
|------------------------------|--------------|-------------------|
| <u>DESIGN COMMISSION</u> | | <u>2,500</u> |
| Artistic Director | 1000 | |
| Designer | 1000 | |
| Associate Designer | 500 | |
| <u>CREATION COSTS</u> | | <u>9,250</u> |
| Recce/Planning | 300 | |
| Staging | 2000 | |
| Set and Props | 2500 | |
| Costumes | 1500 | |
| Lighting | 500 | |
| Usage Fees (Plays, Films) | 150 | |
| Script Preparation | 200 | |
| Transport and Petrol | 650 | |
| Storage | 100 | |
| Casting Expenses | 300 | |
| Rehearsal Space Hire | 500 | |
| Rehearsal Expenses | 50 | |
| Insurance | 500 | |
| <u>PRODUCTION TEAM</u> | | <u>3,500</u> |
| Design Team/Director | 800 | |
| Labour for Set Build | 900 | |
| Stage Management | 1800 | |
| Assistant Stage Managers | 0 | <i>DA Interns</i> |
| <u>PERFORMERS</u> | | <u>5,370</u> |
| Actors | 1800 | |
| Hosts | 930 | |
| Small Gigs | 1600 | |
| Speakers | 840 | |
| Big Gigs | 0 | |
| Djs | 200 | |
| <u>RUNNING COSTS</u> | | <u>1,880</u> |
| Set Maintenance | 200 | |
| Wardrobe Maintenance | 100 | |
| Food/Drink | 880 | |
| PA Hire | 400 | |
| Projector | 300 | |
| <u>MARKETING</u> | | <u>1,000</u> |
| Design/Print | 500 | |
| Photography | 500 | |
| <u>PROJECT OVERHEADS</u> | | <u>2,350</u> |
| Management/Coordination Fees | 2350 | |
| SUBTOTAL | 25850 | |
| CONTINGENCY | 1293 | |
| TOTAL EXPENSES | 27143 | |

DASH ARTS

"Work of profound worldwide artistic significance, awakening us to new styles, beliefs and voices"
Toronto Star



Dash Arts creates artistic experiences that change the way we see the world. Founded in 2005 by Artistic Directors, Josephine Burton and Tim Supple, Dash Arts has rapidly emerged as a unique international creative force, producing new theatre, dance, music and art events in collaboration with exceptional artists from abroad.

"The most magical, fantastical Dream that will be remembered for decades"
The Daily Telegraph on A Midsummer Night's Dream (2006)



Dash Arts has created award winning new work in India, North Africa and the Middle East and currently has projects in development in the post Soviet region, South America and the Far East.

"Wonderful, world class theatre."
Independent on Sunday on One Thousand and One Nights (2011)



Dash Arts productions are created in collaboration with leading venues and festivals in the UK and abroad including National Theatre, Sadler's Wells, Roundhouse, Edinburgh International Festival, RSC, Lincoln Center Festival New York, Luminato Festival Toronto and Ballet Moscow.

"An inspiring night of contrast and contemplation, culminating in a raucous classic hip-hop performance breathed new life into the genre"
The Independent on Lyrical Alliance (2010)



Dash Arts reaches large audiences across the world. Major tours in the UK, Europe, Australia and North America have been widely acclaimed and led to numerous awards and nominations including Olivier, Evening Standard, TMA, Herald Angel and Dora.

"The most boisterous, infectious and downright uplifting live performance I've ever seen."
Time Out on Gogol Bordello (2005)



Outstanding Dash Arts successes include the award-winning Indian *A Midsummer Night's Dream* which played sell out seasons with the RSC in Stratford and at London's Roundhouse before touring world-wide and the double Olivier-award winning *Babel* which was a major success at London's Sadler's Wells and across the world.

"The most fiercely resonant dance theatre of the decade"
The Guardian on Babel (2010)



Dash Arts innovative participation events and workshop programmes engage thousands of young people, students and artists in the UK and abroad. Our fundraising success has so far resulted in £5m of support.

Images from top to bottom:
A Midsummer Night's Dream, Babel, Lyrical Alliance, One Thousand and One Nights, Gogol Bordello, As You Like It

**For more information, contact Sherry Neyhus, Dash Arts Administrative Producer,
sherry@dasharts.org.uk 0207 377 6606 www.dasharts.org.uk**